

RACCORDS A SOUDER

WELDING COUPLINGS

TYPE PETROLE SCH.40
ACIER AE 250 :

SCHEDULE 40 STEEL AE 250 :

Réductions concentriques :

Concentric reducers :

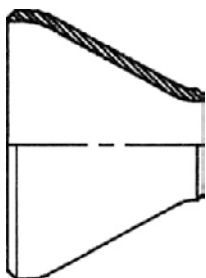

3/4" x 1/2"	1" x 3/4"	1" 1/4 x 3/4"	1" 1/4 x 1"
R2015	R2520	R3220	R3225
1" 1/2 x 1"	1" 1/2 x 1" 1/4	2" x 1"	2" x 1" 1/4
R4025	R4032	R5025	R5032
2" x 1" 1/2	3" x 2"	3" x 2" 1/2	
R5040	R8050	R8065	

Tes égaux :

Straight tees :

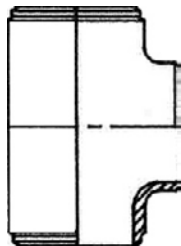

3/4"	1"	1" 1/4	1" 1/2
T20	T25	T32	T40
2"	2" 1/2	3"	
T50	T65	T80	

Tes réduits :

Reducing outlet tees :

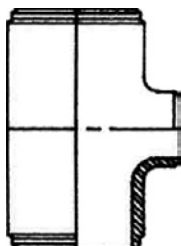

1" 1/4 x 1" x 1" 1/4	1" 1/2 x 1" 1/4 x 1" 1/2	2" x 1" 1/4 x 2"	2" x 1" 1/2 x 2"
TR322532	TR403240	TR503250	TR504050
3" x 2" x 3"	3" x 2" 1/2 x 3"		
TR805080	TR806580		

Courbes 90° 3D :

90° elbows :



3/4"	1"	1" 1/4	1" 1/2
C20	C25	C32	C40
2"	2" 1/2	3"	
C50	C65	C80	

BORNES DE DEPOTAGE

KITS FOR FILLER VALVE
DISPLACED

Série DV325 :

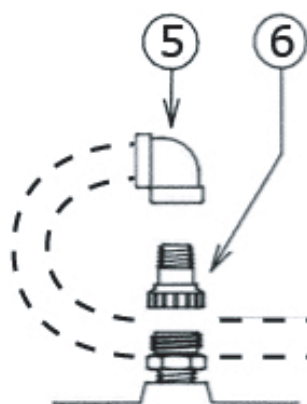

Citerne / Tank

DV325 Series :

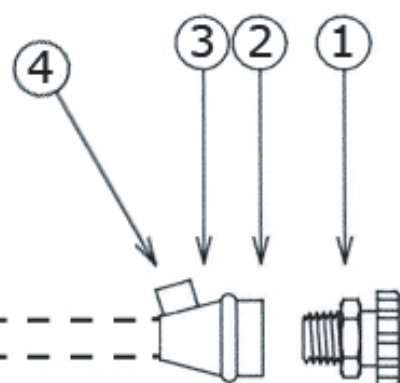
Tube acier 1" tarif III sans soudure non fourni par EQF

Série DV232 :

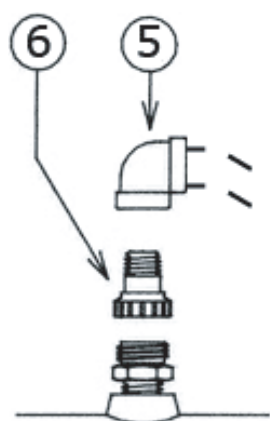

Citerne / Tank

DV232 Series :

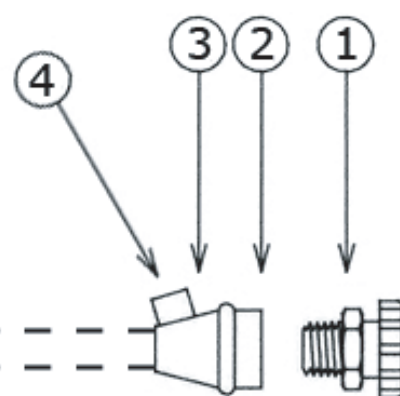
Tube acier 1" tarif III sans soudure non fourni par EQF

DESIGNATION	REP	REFERENCE NUMBER	DESCRIPTION
DOUBLE CLAPET DE REMPLISSAGE	1	VRN20	DOUBLE CHECK FILLER VALVE
REDUCTION ACIER	2	DV324-1	COUPLING
REDUCTION 2" X 1"	3	R5025	REDUCTION 2" X 1"
PLAQUETTE LAITON	4	DVP	BRASS PLATE
COUDE F 1" X F 1"	5	CFF25	CURVE F 1" X F 1"
ADAPTEUR LAITON	6	RD40	FILLING CONNECTOR

BORNES DE DEPOTAGE

KITS FOR FILLER VALVE
DISPLACED

Borne de dépotage pour raccordement de plusieurs citernes.

One filler valve to connect several tanks.

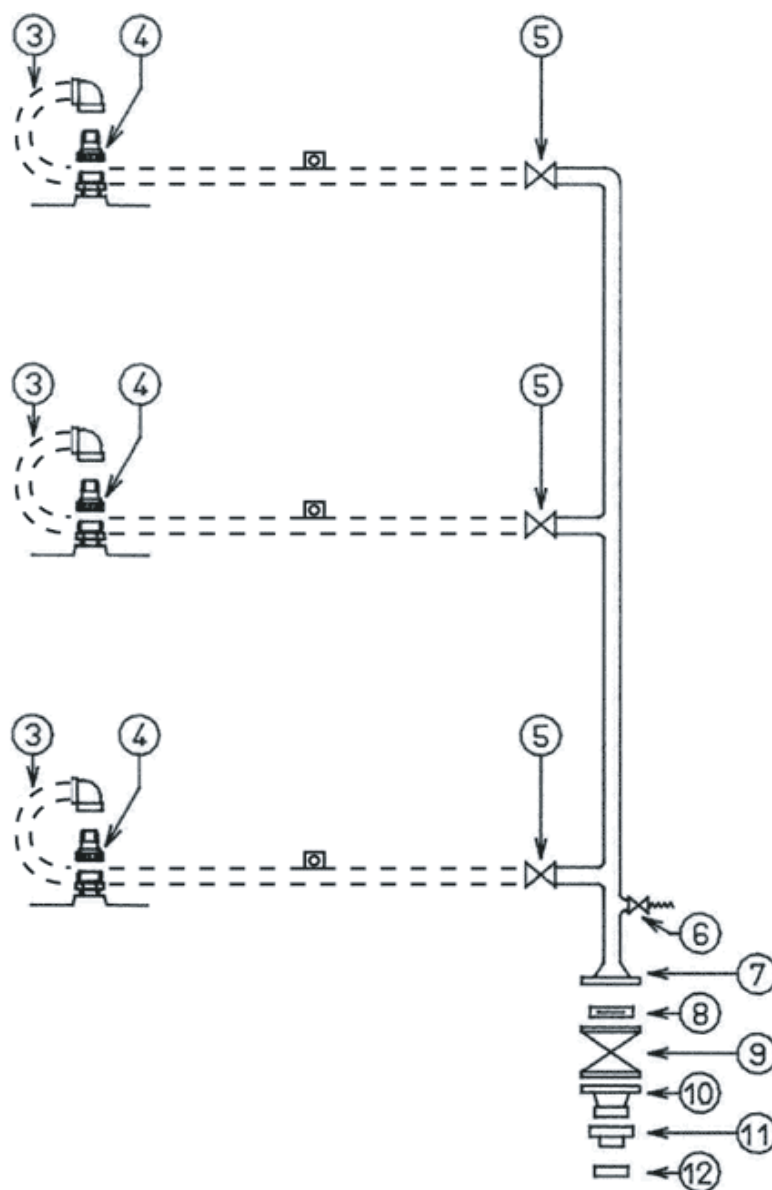

Tube acier 1" tarif III sans soudure non fourni par EQF

DESIGNATION	REP	REFERENCE NUMBER	DESCRIPTION
RACCORD ACIER	3	DV323	ELBOW ADAPTOR
ADAPTEUR LAITON	4	RD40	FILLING CONNECTOR
VANNE 1/4 TOUR ACIER A SOUDER 1"	5	W25S	BUTT WELD BALL VALVE 1"
SOUPAPE 1/4" AVEC 1/2 MANCHON 1/4"	6	S109	RELIEF VALVE 1/4"
BRIDE A COLLERETTE PN50 DN50	7	BSC5050	WELDING NECK FLANGE PN50 DN50
ANTI RETOUR A DISQUE INOX 2"	8	ARD50	2" BACK CHECK VALVE
ROBINET 1/4 TOUR 2" SECURITE FEU	9	W50ASASF	2" BALL VALVE SAFE FIRE
RACCORD M 3" 1/4 ACME + BRIDE PN50 2"	10	RD21A	COUPLING M 3" 1/4 ACME + FLANGE 2" PN50
RACCORD F 3" 1/4 ACME + M 1" 3/4 ACME	11	RD50	COUPLING F 3" 1/4 ACME + M 1" 3/4 ACME
BOUCHON LAITON F 1" 3/4 ACME	12	RD66	PLUG F 1" 3/4 ACME