

# PUMPING

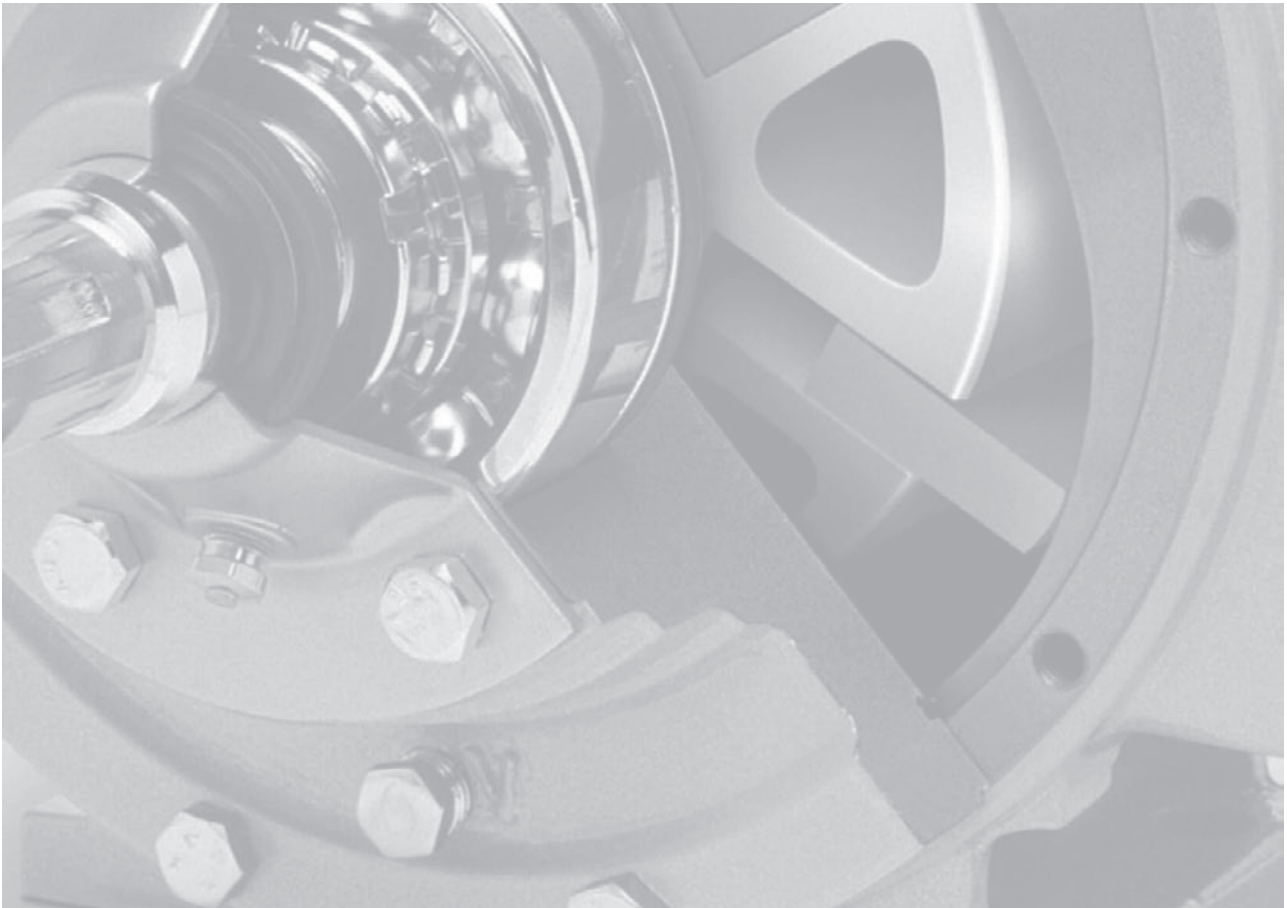

## ROTARY VANE PUMP

The sliding vane pump consists of a rotor turning inside a cam that is machined eccentrically in relation to the rotor. As the rotor turns, the liquid that is trapped between the rotor, cam and vanes is displaced. The RVP-Series pumps are made with vanes produced from advanced polymers which exhibit extremely low coefficients of friction. The self adjusting vanes compensate for wear and help extend the life of the pump. Due to its efficiency the pumps can handle viscous and also volatile liquids and require less horsepower than other equivalent pumps. The pumps are capable of higher flow-rates at lower number of revolutions than other designs.

## PUMPING

### PUMPS

#### OVERVIEW :

RVP Series pumps are rotary vane type, self-priming, provided with integral by-pass valve to protect the pump and system against overpressure.

Originally designed for fuel and light petroleum products applications, Sampi RVP pumps are also available in special executions for industrial and chemical products like solvents, resins, inks.

#### MAIN APPLICATIONS :

Mobile Systems (road tankers)  
On Road Tankers, SAMPI offers different solutions :

- Direct drive from truck PTO through cardan joint.
- Hydraulic Motor drive with adaptor, (oil to be supplied by truck systems).
- Pumping set with Diesel Engine with baseplate to fix on truck chassis.
- Customized solutions including pump, meter, hose reel, accessories, to match installation requirements for any kind of truck.

Stationary Systems (terminals, bulk plants and dispensing points)  
SAMPI pumps are supplied on metallic baseplate, coupled to:

- Electric motors with belt & pulley or gear box drive.
- Diesel Engines, where electric supply is not available.
- High Flow dispensers, with electric motors, with rubber hose and nozzle, also with hose reels for long distance dispensing, marine and aviation refuelling.



RVP series pumps can be supplied upon request in ATEX II 2 G version (applicable to ZONE 1), also with overheat temperature switch (optional).

#### OVERVIEW :

- Strainers
- Hydraulic Motor Adaptor
- Pneumatic By-pass actuator



RVP20

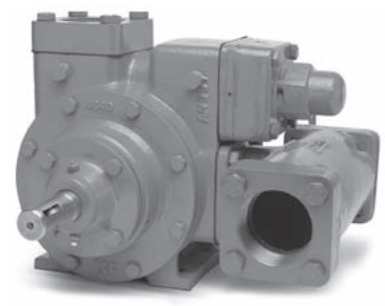

RVP25 with Strainer



RVP30

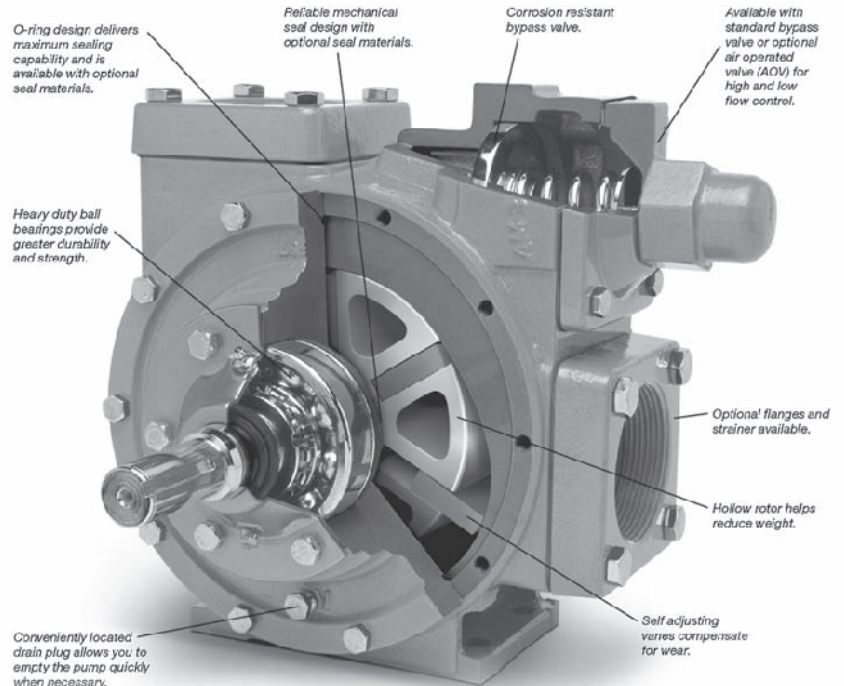

#### MAIN DATA :

MODEL		780 RPM	640 RPM	520 RPM	420 RPM	350 RPM	275 RPM
		l/min(Usqpm)	l/min(Usqpm)	l/min(Usqpm)	l/min(Usqpm)	l/min(Usqpm)	l/min(Usqpm)
RVP20	2"	333(88)	272(72)	216(57)	178(47)	145(38)	117(31)
RVP25	2"1/2	602(159)	484(128)	397(105)	322(85)	268(71)	220(58)
RVP30	3"	-	1026(271)	814(215)	677(179)	568(150)	454(120)



# PUMPING (Pumping system)

## ELECTROPUMPS

### COMMON APPLICATIONS :

- Liquids Transfer in Terminals and Bulk Plants
- High Flow Dispensers
- Combined Pumping & Metering Systems
- Mobile Pumping Units

DRIVE STYLE	
BELT & PULLEYS	GEARBOX
Cheap and compact version, suitable for light applications with low power and low torque at pump shaft.	Suitable for high torque values at pump shaft, very low speed.
Normally used with low viscous products	Recommended for heavy duty applications and with medium-high viscous products.

### MAIN DATA :

- Motor Power from 1 to 30 HP (0,75 to 22 kW), TEFC (IP 55) or explosion proof (ATEX) (upon request, available with voltage/frequency)
- Flow rates from 100 to 1000 l/min.



Electropump with belt & pulleys



Electropump with gearbox

## ENGINE DRIVEN PUMPS

### COMMON APPLICATIONS :

- Where power supply is not available
- Liquids Transfer in Terminals and Bulk Plants.
- Combined Pumping & Metering Systems
- Mobile Pumping Units

### MAIN DATA :

- Drive by belt & pulleys or by gearbox
- TWO-cylinder Diesel Engines from 5 to 28 HP.
- Flow rates from 300 to 1000 l/min.
- With manual or electric start (key and batteries)
- Available also in flame-proof execution



Dieselengine pump

## HYDRAULIC SYSTEMS

### COMMON APPLICATIONS :

- On Road Tankers, for liquid dispensing.

SYSTEM	
DIRECT TO PTO	HYDRAULIC MOTOR
Direct coupling to PTO through cardan joint.	Pump with adapter and coupling for hydraulic motor; Truck must be provided with high pressure hydraulic oil system.
Possible for trucks provided with PTO with suitable speed limitation device.	Can be adapted to any existing system with suitable oil capacity/pressure.

### MAIN DATA :

- Hydraulic Motors with max continuous power from 9 to 16,5 HP
- Max continuous motor speed from 750 to 775 rpm



Hydraulic motor adaptor kit for RVP



Pumpset with hydraulic motor

## PUMPING (Pumping accessories)

### INLET FILTERS

#### OVERVIEW :

SAMPI offers different type of filters, T-type, Basket, Separator, to match any specific application, flow rate, product and filtration degree.



T-type strainer for RVP pumps



Basket Strainer

### ELECTRIC PANELS

#### OVERVIEW :

SAMPI offers electric panels to control any motor pump set, either for direct or star-delta start, with local and/or remote start/stop and emergency stop buttons, according to CENELEC, ATEX and any other international standards.



ATEX Electric panel START-STOP for pumps



ATEX Special electric panel



ATEX Special START-STOP electric panel



## PUMPING

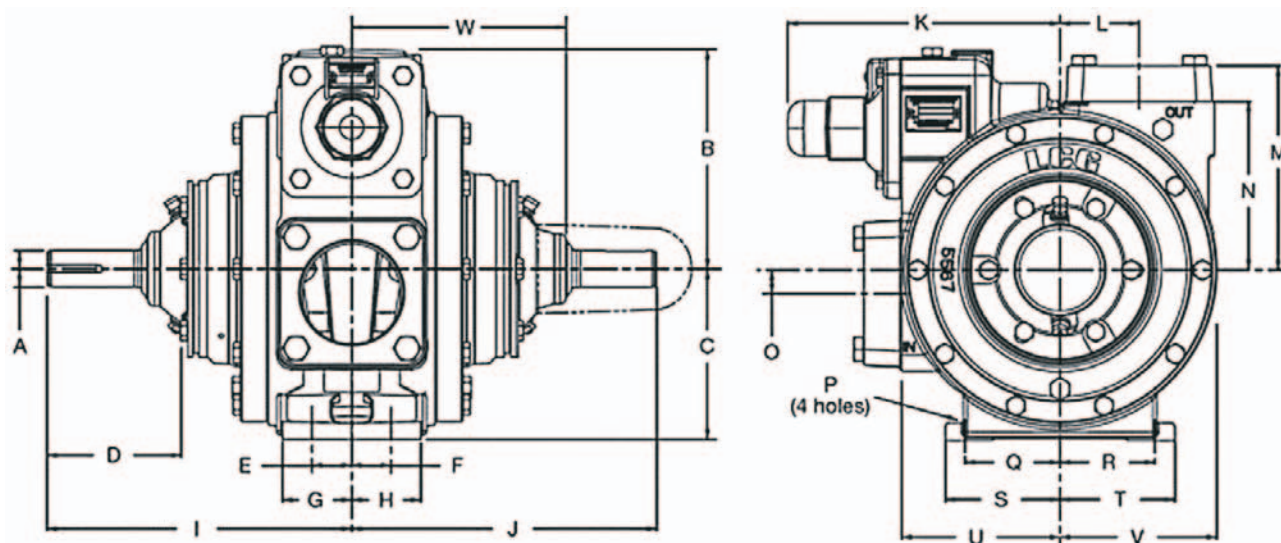

### ALL DIMENSIONS IN INCHES AND (CENTIMETERS)

MODEL	A	B	C	D	E	F	G	H	I	J	K
RVP20	1.125 Dia. (2.86)	5.18 (13.16)	4.00 (10.16)	3.63 (9.22)	0.81 (2.06)	0.81 (2.06)	1.75 (4.45)	1.75 (4.45)	8.00 (20.32)	8.00 (20.32)	6.05 (15.44)
RVP25	1.125 Dia. (2.86)	6.64 (146.87)	4.00 (10.15)	3.63 (9.22)	1.50 (3.81)	1.50 (3.81)	2.45 (6.215)	2.45 (6.215)	9.45 (23.99)	8.75 (22.23)	6.80 (23.99)
RVP30	1.125 Dia. (2.86)	6.93 (17.60)	5.38 (13.70)	4.25 (10.80)	1.25 (3.20)	1.25 (3.20)	2.19 (5.60)	2.19 (5.60)	9.63 (24.40)	9.63 (24.40)	8.60 (21.80)

MODEL	L	M	N	O	P	Q	R	S	T	U	V	W
RVP20	1.50 (3.81)	4.98 (12.66)	4.13 (10.48)	0.50 (1.27)	0.44 Dia. (1.12)	2.50 (6.35)	2.50 (6.35)	3.31 (8.40)	3.31 (8.40)	3.90 (9.92)	3.90 (9.92)	5.30 (13.46)
RVP25	1.75 (4.45)	1.75 (4.45)	5.06 (12.86)	0.25 (0.64)	0.44 Dia. (1.12)	2.75 (6.99)	2.75 (6.99)	3.50 (8.89)	3.50 (8.89)	4.31 (10.95)	3.87 (9.87)	6.05 (15.36)
RVP30	2.50 (6.40)	2.50 (6.40)	5.31 (13.50)	0.75 (1.90)	0.63 Dia. (1.58)	3.00 (7.60)	3.00 (7.60)	3.63 (9.20)	3.63 (9.20)	5.00 (12.70)	4.95 (12.60)	6.43 (16.33)